

oneALDWYCH  
LONDON

ONE GREAT  
EVENT  
2018





## CONTENTS

<b>Introduction</b>	<b>3</b>
<b>Private Room Capacities</b>	<b>4</b>
<b>The Adelphi &amp; Novello Rooms</b>	<b>6</b>
<b>The Lyceum Room</b>	<b>7</b>
<b>The Screening Room</b>	<b>8</b>
<b>Lounge at One</b>	<b>9</b>
<b>Eneko - Basque Kitchen &amp; Bar</b>	<b>10</b>
<b>Daily Delegate Rates</b>	<b>11</b>
<b>Private Movie Party</b>	<b>12</b>
<b>Menus</b>	<b>13</b>
<b>Bedrooms &amp; Suites</b>	<b>14</b>
<b>Social Events</b>	<b>15</b>
<b>Flowers at One</b>	<b>15</b>
<b>Weddings</b>	<b>16</b>





# ONEALDWYCH

LONDON

One Aldwych is an award-winning contemporary luxury hotel in the heart of Covent Garden. With 105 beautiful bedrooms and suites, the hotel offers thoughtful and professional service throughout; providing an uplifting backdrop for any gathering.

Its location in the cultural centre of London is unbeatable, with the Royal Opera House and over 25 major theatres within a ten-minute walk, as well as restaurants and stylish shopping on its doorstep.

With six versatile spaces for meetings and private dining, there are endless possibilities to host a memorable event at One Aldwych.

## Added Value For Groups

Parties reserving eight or more rooms at One Aldwych will enjoy the following benefits:

- An exclusive arrival experience for the group, with complimentary coffee, tea and pastries, and a spa therapist on hand to provide head, neck and shoulder massages\*
- Complimentary daily breakfast
- 15% discount off treatments in The Health Club from Sunday to Friday
- Complimentary cocktail demonstration when booking a private room for dinner\*
- Complimentary pressing on arrival (two items per person)

\*subject to group numbers



# PRIVATE ROOM CAPACITIES

Whether you are planning a board meeting, an exquisite private dinner or a fun movie screening, One Aldwych offers a variety of beautiful spaces.

## Capacities

Room	U-shape	Boardroom	Theatre	Dinner	Reception
The Adelphi Room	-	18	24	20	30
The Novello Room	-	16	18	20	25
The Adelphi & Novello Rooms	30	35	60	50	80
The Lyceum Room	-	20	24	30	40
The Screening Room	-	-	30	-	-
Lounge at One	-	-	-	-	50
Eneko Basque Kitchen & Bar	-	-	-	110	150

Capacities may alter depending on any audio-visual equipment in the room or catering requirements.









## THE ADELPHI & NOVELLO ROOMS

The Adelphi and Novello Rooms are located next door to each other on the mezzanine level and can be used separately or combined together. From boardroom style meetings to elegant cocktail receptions, these versatile rooms are ideal for both private celebrations and business events.

The beautiful Adelphi and Novello Rooms display vivid pieces of contemporary art and large windows which provide natural daylight and an inspiring backdrop of busy London life. The room also offers full air conditioning, as well as complimentary WiFi.

### Capacities

	Adelphi	Novello	Combined
Boardroom with screen	15	13	30
Boardroom without screen	18	16	35
Theatre	24	18	60
Round tables	20	20	50
Oval table	18	16	35
Reception	30	25	80
U-shape	-	-	30
Cabaret	-	-	28

### THE ADELPHI AND NOVELLO ROOMS

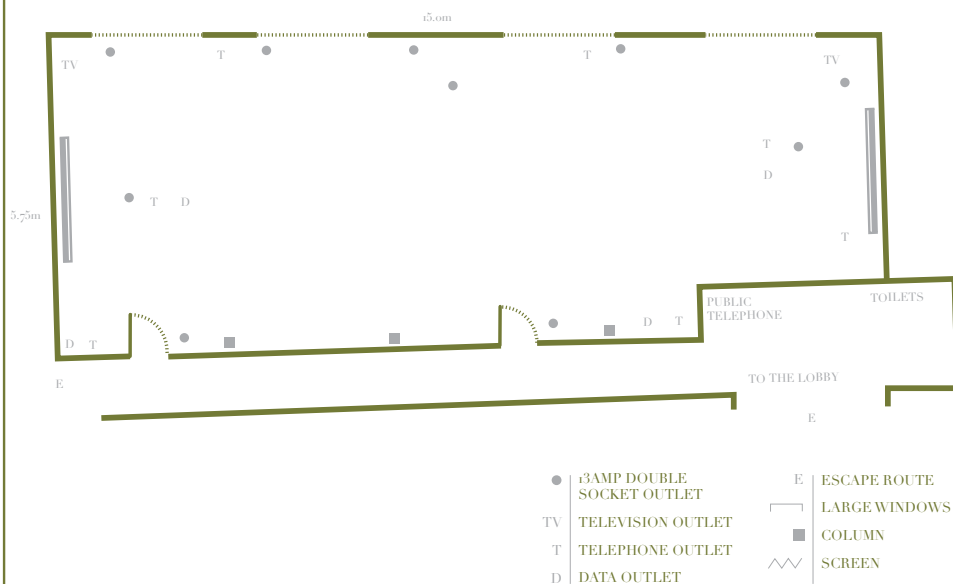

### Room Size

The Adelphi & Novello Rooms Combined  
 15 x 5.75 metres | 86 square metres  
 Ceiling height 2.4 metres

49.2 x 18.9 feet | 926 square feet  
 Ceiling height 7.5 foot



## THE LYCEUM ROOM

The Lyceum Room is a beautiful contemporary space with wooden flooring and calm, inspiring art on each wall.

Adjacent to The Screening Room, The Lyceum Room is the ideal space for dinners with friends, business meetings and cocktail receptions, before or after a screening. The room accommodates a maximum of 20 guests on one oval table, 30 guests on three round tables of ten and 40 guests for a standing reception. The room also provides full air conditioning and WiFi.

### Capacities

Boardroom with screen	18
Boardroom without screen	20
Theatre	24
Dinner	30
Reception	40
Cabaret	21

### Room Size

7.5 x 7.1 metres | 53 square metres

Ceiling height 2.4 metres

24.6 x 23 feet | 571 square feet

Ceiling height 7.9 foot

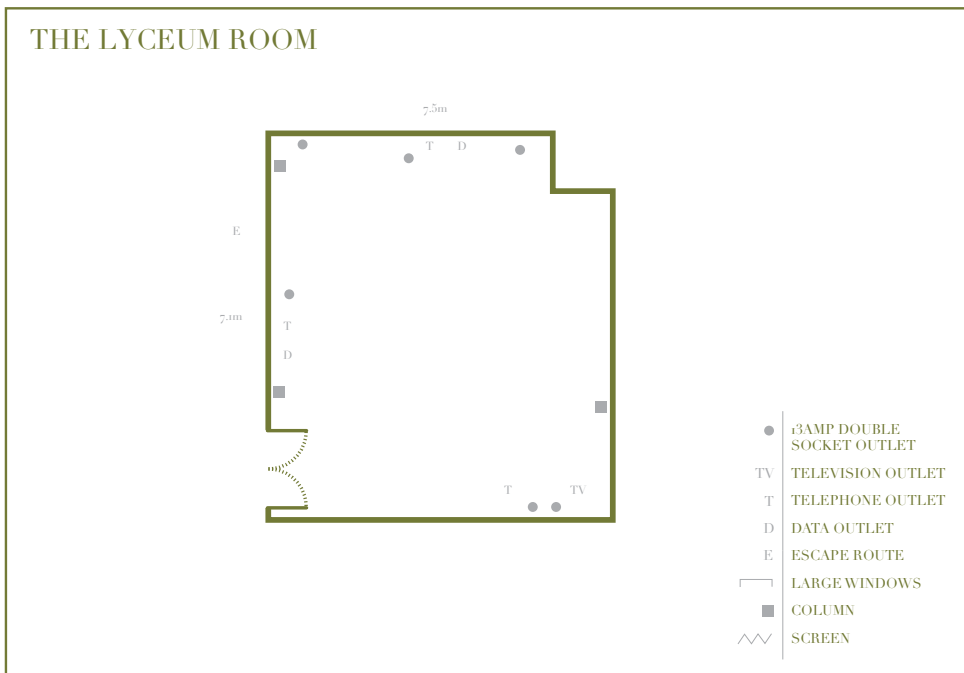

# THE SCREENING ROOM

With graduated leather seating, an experienced Screening Room Technician and plenty of popcorn, our private cinema is set up with everything you need for the perfect presentation or a private film screening.

The Screening Room is situated next to The Lyceum Room, which works well for combining a drinks reception or dinner with your screening or presentation.

## Capacities

Theatre	30
---------	----

## Room Size

8.4 x 7.4 metres | 62 square metres

Ceiling height 2.4 metres

27.6 x 24.3 feet | 667 square feet

Ceiling height 7.9 foot



## Room Information

- 30 graduated Italian leather seats with drink rests
- A lectern for presentations
- 7.1 Dolby Surround Sound
- Full digital HD 1080p Blu-ray playback, Region 2
- Resolution - 2048 x 1080 pixels
- DCI Compliant NEC 2K Digital Projector, DCP Compatible, HFR Capable
- Full compatibility with PowerPoint
- TV broadcasts from BBC 1 HD, BBC 2 HD, ITV HD, Channel 4 and 5 HD
- Capability to play from multi-region DVD Player and DVD upscaling
- Capability for HD video player (advance notice required)
- Capability for HD Cam, HD Cam SR and DVC Pro HD (additional cost)
- Connection for video game consoles





## LOUNGE AT ONE

The Lounge at One is an elegant, stylish area located on the ground floor.

The perfect environment for an intimate drinks reception for up to 50 guests. The lounge features comfortable sofas and stunning floral arrangements, making all options available.

The lounge also boasts a collection of beautiful books on fashion, design, architecture and travel, as well as a selection of contemporary art pieces.

### Capacities

Reception

50



# ENEKO BASQUE KITCHEN & BAR

Eneko is the stylish and informal restaurant from the acclaimed three Michelin-starred chef, Eneko Atxa.

Showcasing a modern take on traditional Basque food, Eneko offers playful dishes and decadent desserts in a relaxed setting. The food celebrates the flavours of northern Spain and ranges from delicate canapés to family style sharing dishes perfect for any party. The restaurant has a touch of the beautiful Basque region, with many materials sourced from local craftsmen and given a distinct London edge.

With its own private entrance, guests will arrive down the grand copper staircase into the bar to enjoy wine from the carefully crafted all-Spanish wine list, including a selection from Eneko's family winery, Gorka Izagirre.

## Capacities

Lunch or Dinner	110
Reception	150







## DAILY DELEGATE RATES

The stunning private rooms at One Aldwych offer a bright and inspiring backdrop for your meeting. Well located for both the City and the West End, the hotel offers daily delegate rates that are excellent value for meetings of ten or more people.

*£110 per person, including:*

- Room hire from 7am to 5pm
- Pads, pencils and mints
- LCD projector and screen or plasma screen (46")
- Complimentary WiFi
- Water throughout the day
- Home-baked Danish pastries, croissants and mini muffins on arrival
- Two servings of coffee, tea or herbal tea and a snack during the day
- Working buffet lunch served in the meeting room

Bookings must be for a minimum of ten people for The Adelphi, Novello and Lyceum Rooms and for a minimum of twenty people for The Adelphi and Novello Rooms combined.

All prices are inclusive of VAT at the current rate. There is an additional, optional service charge of 12.5% for food and beverage.



## PRIVATE MOVIE PARTY

For a unique way to entertain, host a movie party for up to 30 people in our digital HD Screening Room with 7.1 Dolby Surround Sound.

Sink back into the luxurious leather armchairs with a glass of Lallier Grande Réserve Champagne and popcorn to watch the film of your choice. Then indulge in a decadent two-course modern British lunch or dinner in The Lyceum Room.

*£95 per person, including:*

- One glass of Champagne
- Sweet and salty popcorn
- Two-course lunch/dinner menu or afternoon tea
- Room hire of The Lyceum Room and The Screening Room
- Experienced Screening Room Technician

DVD or Blu-ray disc to be supplied by guest.

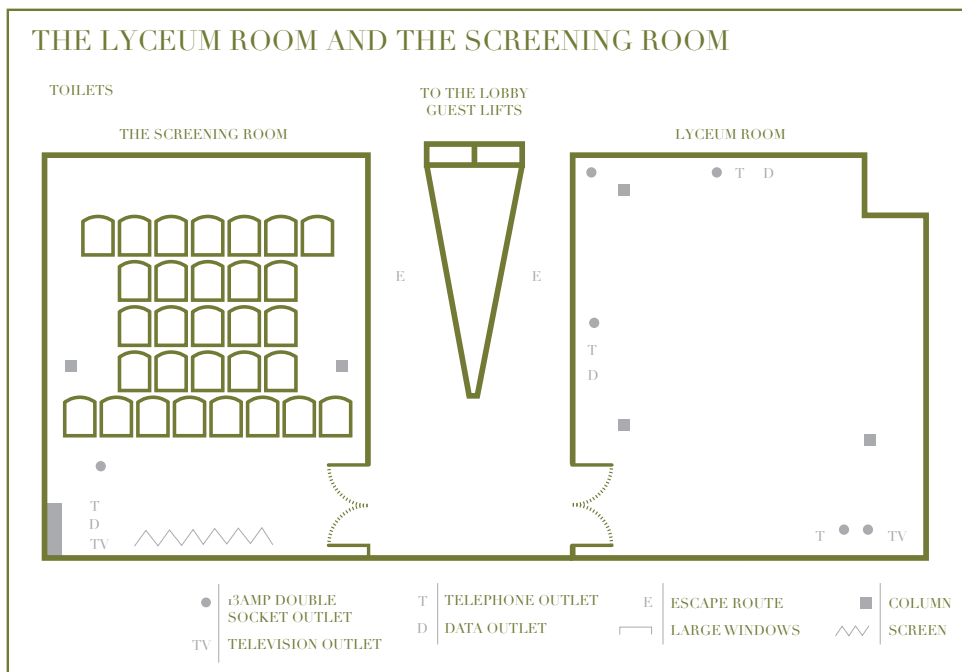



# MENUS

Whether it is an energy boosting breakfast, an afternoon tea with a difference, original canapés for a fun party or a decadent dinner, Executive Chef Dominic Teague's carefully crafted menus, incorporating fresh, seasonal and responsibly sourced ingredients are sure to delight.

Breakfast	From £26
Breakfast canapés	£30
Tea, coffee and pastries	£12
Working lunch buffet	£45
One signature buffet	£55
Three-Course lunch or dinner	From £65
Canapés (6 items)	£20
Afternoon tea inspired by Charlie and the Chocolate Factory	£62 with a glass of Champagne

*All costs per person.*

Mineral water	£5.50 a bottle
Orange juice	£5.50 a glass
Soft drinks	From £4 a bottle
Wine	From £32 a bottle
Prosecco	From £46 a bottle
Champagne	From £80 a bottle

All prices are inclusive of VAT at the current rate. All food and beverage rates exclude an optional service charge of 12.5%.



## THE CHEF'S DINING EXPERIENCE

To make your event even more spectacular, wow your guests with our tailored and interactive dining experience.

Start the event with a personal introduction from Chef Dominic Teague, with the option of a private tour of the hotel's state-of-the-art kitchen, before learning more about the ingredients used in Dominic's signature dishes. Take a seat in one of our stunning private dining rooms for a five-course Signature Menu, crafted by Chef Dominic.

**£130 per person, minimum of ten guests.**

## BEDROOMS & SUITES

One Aldwych has 93 contemporary bedrooms and 12 suites, each beautifully designed with extensive care and attention to detail. Cool, calm interiors are given the luxurious touch with sumptuous silks, bespoke furniture and the finest linen.

### Thoughtful Little Touches

All guests staying at One Aldwych benefit from:

- Unlimited complimentary WiFi
- Daily deliveries of perfectly ripe fruit
- Fresh flowers placed in your room every day
- Access to the private guest lounge, Lounge at One
- Use of The Health Club and 18-metre, chlorine-free swimming pool
- Access to over 3,000 publications online via complimentary download of the PressReader App





## SOCIAL EVENTS

In the heart of London, One Aldwych is the perfect destination for hosting an exciting experience for any occasion.

From a traditional Champagne breakfast, to a Charlie and the Chocolate Factory-inspired private afternoon tea, we can make your event happen.



## FLOWERS AT ONE

For eye-catching displays, Mark Siredzuk of Flowers at One, our in-house florist, is on hand to create magnificent arrangements and installations to add the wow factor to your event. To discuss your floral requirements, please contact our Events Team.

## WEDDINGS

One Aldwych is also the perfect place for organising your special day. For an intimate and romantic wedding breakfast with up to 110 guests, we offer a beautiful venue for a day to remember. We are also licensed to hold your civil ceremony at One Aldwych for up to 70 guests. For more information please contact our events team.





# ONEALDWYCH

LONDON

## CONTACT US

For further details or to arrange a visit to the hotel,  
please contact the Events Team at One Aldwych.

Tel 020 7300 0700 | Email: [events@onealdwych.com](mailto:events@onealdwych.com)

One Aldwych, London WC2B 4BZ

[onealdwych.com/events](http://onealdwych.com/events)

