

SUMMER CANAPÉ RECEPTION PACKAGE



No.4

Hamilton
Place

With the elegant old-world grandeur of the Edwardian Town House, and its wonderful location in Mayfair, the Argyll Room and Terrace at **No.4 Hamilton Place** is a stunning venue for a Canapé Food Reception.

The picturesque, heated roof terrace with views over Hyde Park is one of a select few locations in Central London offering an exclusive, outside area for up to **200 guests**. The terrace provides the option for a full or half tent, making it a transformable space for events all year round. The canapé package gives guests a selection of light bites and refreshing drinks to enjoy on a warm day or evening.

Catering is by Blue Strawberry, one of London's leading catering companies, renowned for their innovative events with creative and delicious food. Their unparalleled menus are intelligently designed and expertly prepared by a highly skilled chef brigade. Blue Strawberry's passionate team go to great lengths to make anything possible, no matter what the request.

The Summer Canapé Reception Package includes:

- Venue hire of the Argyll Room and Terrace (6pm -10pm)
- Six canapés per person
- Unlimited house wine, beer and soft drinks (6pm-10pm)
- A dedicated Event Manager

£80 plus VAT per person

Minimum numbers of 80 guests apply. Bespoke packages available for smaller parties.

BOOK TODAY

0207 670 4314 / 4316 | hello@4hp.org.uk | 4hp.org.uk/events/summer-parties

Recommended Itinerary

6.00pm	Guests arrive for welcome drink
6.30pm	Canapé service
9.45pm	Last orders
10.00pm	Carriages

Situated alongside Park Lane hotels there is an abundance of taxis available

Sample menu* courtesy of in-house caterers Blue Strawberry, where innovative food and creative design become an exceptional experience

All dietary requirements can be catered for.

Cold Canapés

Steak tartar, whole grain mustard mayonnaise, gherkin, charred sour dough

Smoked chicken roulade, butter milk curd, smoked tomato pesto

Cod brandade, crispy skin, smoked tomato, tomato ketchup

Cauliflower panna cotta, vanilla oil, lemon and coriander (v)

Hot Canapés

Homemade lamb prosciutto, Welsh rarebit, pea and anchovy

Crispy duck leg, ginger dressing, hoi sin mayonnaise

Puffed scallop wonton, yuzu avocado purée, pickled turnip and peanut

Basil and artichoke arancini (v)

Beer and miso aubergine, peanut crumble, Gochujang caramel (v)

Dessert canapés

Piña colada mousse, coconut dacquoise, rum and vanilla macerated pineapple

Dulcey crèmeux, Earl Grey streusel

Manjari chocolate millionaire shortbread

Available Upgrades

Four additional canapés	£10.00 per person
Prosecco (first hour of drinks package)	£7.00 per person
Pimms (first hour of drinks package)	£7.00 per person
Arrival cocktail (as part of drinks package)	£4.50 per person
Unlimited spirits upgrade for four hours	£8.00 per person
Snacks and nibbles	£6.00 per person
Dance floor	Price on request
DJ	Price on request
Half Tent	£1350
Full Tent	£2700
Late night opening from 10pm until midnight	£300 per hour
Extension past midnight *	£600 per hour

* subject to approval by Westminster Council

Capacity

80-200 guests

BOOK TODAY

0207 670 4314 / 4316 | hello@4hp.org.uk | 4hp.org.uk/events/summer-parties

All prices exclude VAT

FLOOR PLAN

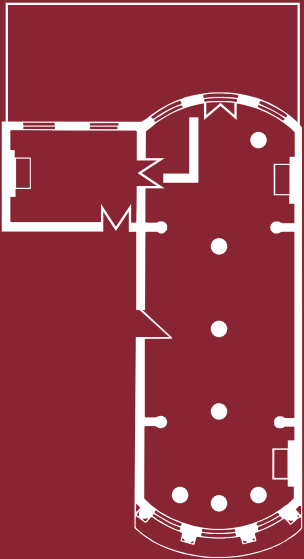

ROOM SIZES

Argyll Room

61' x 21'8" = 1342 sq ft

18.8m x 6.6m = 124 sq m

Hawker Room

13'6" x 17'10" = 1342 sq ft

Ceiling Height

15'10" / 4.9m

