



Tailor made food design by

*“rhubarb”*

[saatchigallery.com/gallerymess](http://saatchigallery.com/gallerymess)

GALLERY

MESS



&

MESS ROOM

Events & Private Dining



“

*I would eat here every night if I lived nearby.*

**Faye Maschler,  
Evening Standard**

”

## Events & Private Dining

“*rhubarb*” food design is delighted to offer this unique and stunning venue for private dining and events. We are proud to be providing food at the Saatchi Gallery restaurant, bar & café at Duke of York’s HQ in the heart of Chelsea. Both the restaurant, bar & café and the outside terrace are breathtaking spaces available for events. Upstairs we also have a superb 800 sq foot private dining room called the Mess Room, where we can create events, receptions and dinners for between 10 and 70 people.

The space features some of the Gallery’s contemporary art and, as always, “*rhubarb*” will be serving a delicious selection of food options – all freshly prepared, cooked and served to the highest standards. Please contact us to find out more about events at Gallery Mess, to see our menus, or to arrange a viewing of the space.

*Just want to say a big thank you to you and your team for looking after us. The day ran seamlessly, with everyone leaving very happy. The service, room and lunch was great.*

*Thank you again for your wonderful service!*

**Futurebrand**

*The dinner brought together key decision makers... attended by our MP, Oliver Letwin, Lord Browne, Professor Iain Steward and other key supporters. We all really appreciated your interest and attention to detail which combined with the excellent food made for a very convivial, relaxed, enjoyable and successful evening.*

**Lyme Regis  
Development Trust**

*The event was very successful and the feedback was extremely positive so thanks to you and your team for all you did to make the event work for us.*

**Lockheed Martin**

# GALLERY MESS

## Gallery Mess

With its exposed brickwork, vaulted ceilings and display of art, the listed interior provides the perfect location for dinner, a long leisurely lunch or drinks. The seasonal menu and extensive bar selection is provided by award winning caterers *“rhubarb”* food design.

The restaurant also benefits from a wonderful al fresco terrace, all of which can be hired exclusively for private events.

“  
*With its enviable Chelsea location, listed interior with vaulted ceiling, and terrace overlooking Duke of York Square - Gallery Mess is a grown up operation, every bit as slick and assured as Saatchi’s meteoric career... dishes are artfully presented (of course), but there’s substance to this style: a new ‘sensation’, perhaps.*  
”  
Timeout



### Opening hours

- 10:00am-11:30pm  
Monday to Saturday
- 10:00am-7:00pm  
Sunday

### Food & Drink

- All menus/drinks created bespoke to clients requirements

### Capacity

- 132 covers  
(sit down dinner or canapé reception)

### Fee

- Please see insert on the back page

### General facts

- Use of all Gallery Mess facilities
- Each event tailored to clients requirements
- Art can be de-installed at a cost
- Music allowed
- No drinks to be taken to the outside terrace after 9.30pm in the summer time or 6.30pm in the winter months

# Mess Room

Mess Room is a light and airy private space available for day and evening hire. The oak flooring and white walls make Mess Room a perfect loft-style flexible space that can be used for a range of private events including receptions, theatre style lectures for up to 80 guests and private dinners for up to 50 guests. Bespoke menus can be provided to suit all budgets and themes.

*“ We all had the most fantastic evening. The food was absolutely brilliant and the staff could not have been more charming and attentive. We were completely blown away by everything. Will you please give everyone a massive thank you from us all. It truly exceeded our expectations and made for a wonderful memorable birthday for Alexander. ”*

Jessica Mackichan



# Mess Room



### Capacity:

- Dinner up to 50 covers
- Canapé & drinks reception up to 70 covers
- Conference forum up to 70 covers (dependant on seating configuration)

- Bespoke menus collated to suit budgets and themed events
- Drinks list supplied on request

### General facts:

- Use of all gallery facilities
- Each event tailored to clients requirements
- Art can be de-installed at a cost
- Music allowed
- Smoking allowed on outside terrace until 11.00pm
- No drinks to be taken to the outside terrace after 9.30pm

### Food & Drink:

- Designed and bespoke selection of menus available each Season

### Fee:

- Please see insert on the back page
- 12.5% gratuity fee applicable to all events held in the PDR space

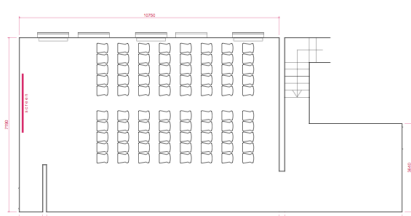
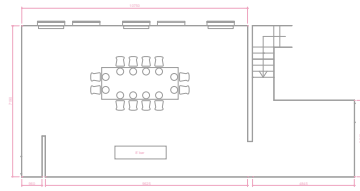
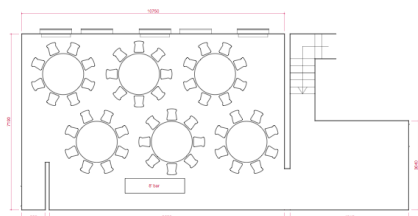

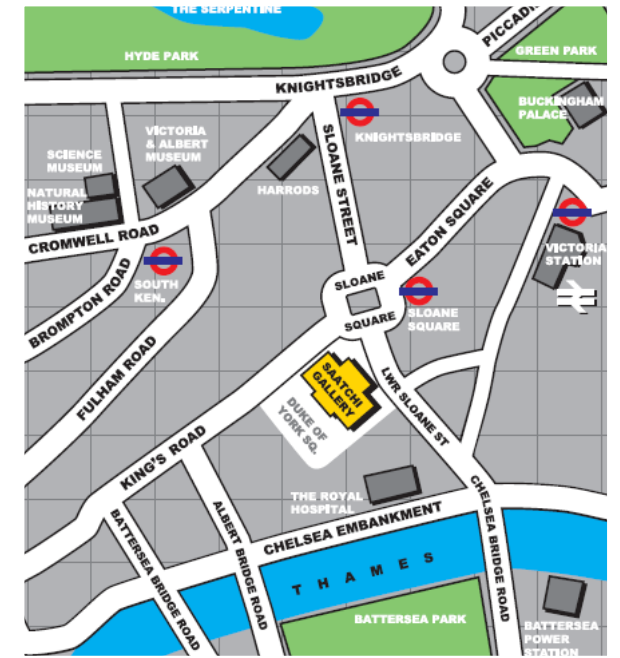

## Gallery Mess & Mess Room

Please contact the team with any queries or booking requests on:

**T: 0207 730 8135**

**A: Saatchi Gallery,  
Duke of York HQ King's Road, SW3 4LY**

[www.saatchigallery.com/gallerymess](http://www.saatchigallery.com/gallerymess)

